

## MANIFOLDS

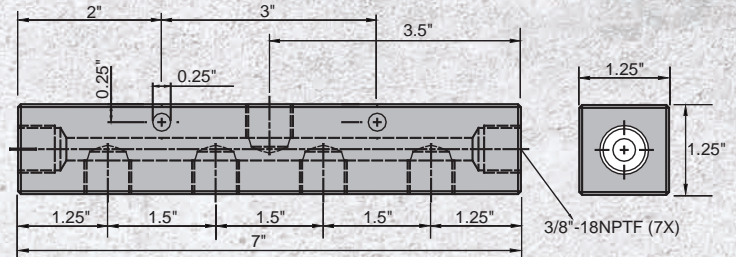

CM7



CM14

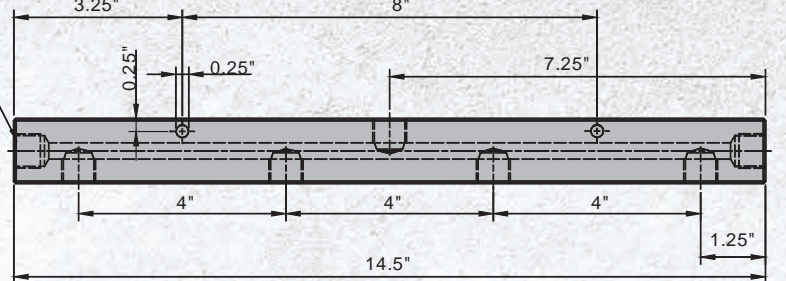
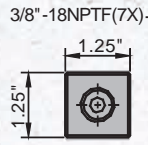

MFC2

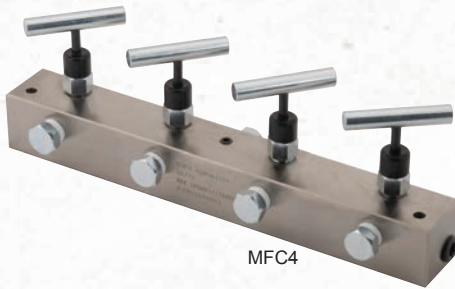
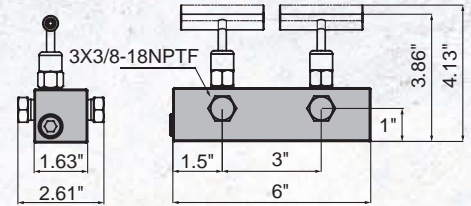

MFC4

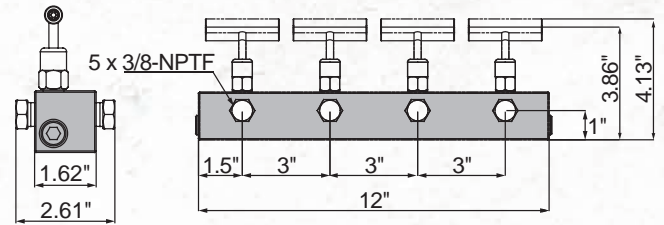

CMH6

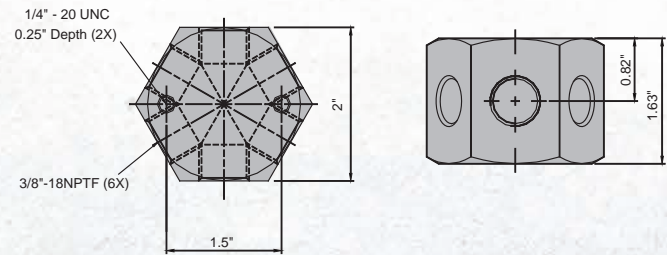

FCMH6

FCMH6

- Controls the flow of 5 hydraulic hoses from one central location
- Sturdy design for long product life
- Convenient carry handle

Manifold Type	Model Number	Number of Ports	Port Size	Mounting Hole
6-Port Hexagon Manifold	CMH6	6	3/8"-18NPTF	1/4"-20UNC
7" Long Manifold	CM7	7	3/8"-18NPTF	1/4"-20UNC
14" Long Manifold	CM14	7	3/8"-18NPTF	1/4"-20UNC
Manifold with Two Needle Valves	MFC2	3	3/8"-18NPTF	4.4
Manifold with Four Needle Valves	MFC4	5	3/8"-18NPTF	10.1
Spider Valves	FCMH6	6	3/8"-18NPTF	-